

GROOVED PINS

785-392-3017 FAX 785.392.2845

REVISED 06-04
www.huyett.com

THREE FULL-LENGTH GROOVES

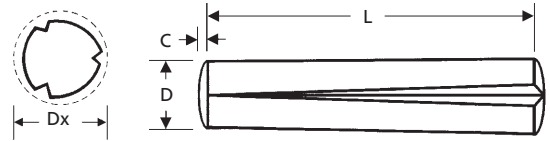

TYPE A

MANUFACTURER CROSS-REFERENCE

ANSI	A	Driv-Lok	A
Groov-Pin	1		

GP-A	Nominal (D)	Length (L)	Expanded Diameter (Dx)	Hole Size	Crown Height (C)	Crown Radius	WEIGHT Lbs. per 100 Pieces	MATERIAL		
	DIAMETER	LENGTH						Zinc Clear "GP."	Alloy HIT "GPA."	Stainless "GPS."
-0062-0250	1/16	1/4	.068	.062	.0065	5/64	0.02			
-0062-0375		3/8					0.03			
-0062-0500		1/2					0.04			
-0062-0625		5/8					0.05			
-0062-0750		3/4					0.07			
-0062-0875		7/8					0.08			
-0062-1000	1	0.09								
-0093-0250	3/32	1/4	.101	.093	.0091	1/8	0.06			
-0093-0375		3/8					0.08			
-0093-0500		1/2					0.10			
-0093-0625		5/8					0.12			
-0093-0750		3/4					0.15			
-0093-0875		7/8					0.17			
-0093-1000	1	0.20								
-0093-1250	1-1/4	0.25								
-0125-0250	1/8	1/4	.134	.125	.0130	5/32	0.09			
-0125-0375		3/8					0.13			
-0125-0500		1/2					0.17			
-0125-0625		5/8					0.22			
-0125-0750		3/4					0.26			
-0125-0875		7/8					0.30			
-0125-1000	1	0.35								
-0125-1250	1-1/4	0.44								
-0125-1500	1-1/2	0.48								
-0156-0375	5/32	3/8	.166	.156	.0170	3/16	0.20			
-0156-0500		1/2					0.27			
-0156-0625		5/8					0.34			
-0156-0750		3/4					0.41			
-0156-0875		7/8					0.48			
-0156-1000		1					0.54			
-0156-1250	1-1/4	0.68								
-0156-1500	1-1/2	0.82								
-0156-1750	1-3/4	0.95								
-0156-2000	2	1.09								
-0187-0375	3/16	3/8	.198	.187	.0180	1/4	0.29			
-0187-0500		1/2					0.39			
-0187-0625		5/8					0.49			
-0187-0750		3/4					0.59			
-0187-0875		7/8					0.69			

GP-A

DESCRIPTION
Three full-length tapered grooves. Ideal for applications requiring superior locking effect and ease of assembly. Use in place of taper pins, set screws, nuts, and lugs.

TYPE A



COMMON

GENERAL USE

HOW TO IDENTIFY

1. Verify three full-length tapered grooves.
2. Measure diameter (D).
3. Measure length (L).
4. Find the part in the chart above.

TYPICAL PART NUMBER SEQUENCE:
GP-0250-0500-A
is a 1/4" x 1/2", type A, steel zinc grooved pin.

APPLICATION

As a lock pin.

PERFORMANCE RESULTS VARY. YOUR PIN SELECTION SHOULD BE MADE BASED ON INDIVIDUAL APPLICATION.

MOST SIZES AVAILABLE IMMEDIATELY • \$2 LINE REQUESTED • CALL FOR QUANTITY DISCOUNTS

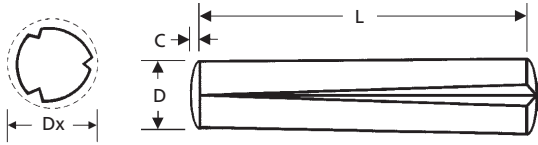
THREE FULL-LENGTH GROOVES

TYPE A
MANUFACTURER CROSS-REFERENCE

ANSI	A	Driv-Lok	A
Groov-Pin	1		



GP-A	Nominal (D)	Length (L)	Expanded Diameter (Dx)	Hole Size	Crown Height (C)	Crown Radius	WEIGHT Lbs. per 100 Pieces	MATERIAL		
	DIAMETER	LENGTH						Zinc Clear "GP-"	Alloy HIT "GPA-"	Stainless "GPS-"
-0187-1000	3/16	1	.198	.187	.0180	1/4	0.78			
-0187-1250		1-1/4								
-0187-1500		1-1/2								
-0187-1750		1-3/4								
-0187-2000		2								
-0218-0500	7/32	1/2	.230	.218	.0220	9/32	0.53			
-0218-0625		5/8								
-0218-0750		3/4								
-0218-0875		7/8								
-0218-1000		1								
-0218-1250		1-1/4								
-0218-1500		1-1/2								
-0218-1750		1-3/4								
-0218-2000		2								
-0218-2250		2-1/4								
-0250-0500	1/4	1/2	.263	.250	.0260	5/16	0.70			
-0250-0625		5/8								
-0250-0750		3/4								
-0250-0875		7/8								
-0250-1000		1								
-0250-1250		1-1/4								
-0250-1500		1-1/2								
-0250-1750		1-3/4								
-0250-2000		2								
-0250-2250		2-1/4								
-0250-2500	5/16	2-1/2	.261	.312	.0340	3/8	1.36			
-0250-2750		2-3/4								
-0312-0625		5/8								
-0312-0750		3/4								
-0312-0875		7/8								
-0312-1000	1									
-0312-1250	1-1/4									
-0312-1500	1-1/2									
-0312-1750	1-3/4									
-0312-2000	2									
-0312-2250	2-1/4									
-0312-2500	2-1/2									
-0312-2750	2-3/4									

DESCRIPTION	GENERAL USE	HOW TO IDENTIFY	APPLICATION
GP-A Three full-length tapered grooves. Ideal for applications requiring superior locking effect and ease of assembly. Use in place of taper pins, set screws, nuts, and lugs. TYPE A	 COMMON	1. Verify three full-length tapered grooves. 2. Measure diameter (D). 3. Measure length (L). 4. Find the part in the chart above. TYPICAL PART NUMBER SEQUENCE: GPA-0312-2000-A is a 5/16" x 2", type A, alloy grooved pin.	 As a drive pin.

PERFORMANCE RESULTS VARY. YOUR PIN SELECTION SHOULD BE MADE BASED ON INDIVIDUAL APPLICATION.

ADDITIONAL TECHNICAL DATA ON PAGE 128.
DIN 1471
METRIC
 Page 232

MOST SIZES AVAILABLE IMMEDIATELY • \$2 LINE REQUESTED • CALL FOR QUANTITY DISCOUNTS

All manufacturer names and numbers are for identification purposes only. In no way are we implying that our parts were made by the manufacturers listed above. Prices, materials, tolerances, and grades subject to change without notice.

GROOVED PINS

785-392-3017 FAX 785.392.2845

REVISED 06-04
www.huyett.com

THREE FULL-LENGTH GROOVES

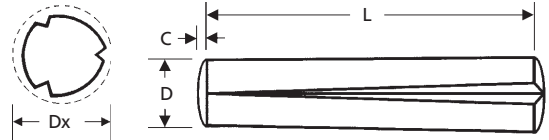

TYPE A

MANUFACTURER CROSS-REFERENCE

ANSI	A	Driv-Lok	A
Groov-Pin	1		

GP-A	Nominal (D)	Length (L)	Expanded Diameter (Dx)	Hole Size	Crown Height (C)	Crown Radius	WEIGHT Lbs. per 100 Pieces	MATERIAL			
	DIAMETER	LENGTH						Zinc Clear "GP-"	Alloy HIT "GPA-"	Stainless "GPS-"	
-0375-0750	3/8	3/4	.394	.375	.0390	15/32	2.35				
-0375-0875		7/8									
-0375-1000		1									
-0375-1250		1-1/4									
-0375-1500		1-1/2									
-0375-1750		1-3/4									
-0375-2000		2	.393	+ .005/- .000							
-0375-2250		2-1/4									
-0375-2500		2-1/2									
-0375-2750		2-3/4									
-0375-3000		3									
-0375-3250		3-1/4									
-0375-3500	3-1/2	.391									
-0437-0875	7/8										
-0437-1000	1										
-0437-1250	1-1/4										
-0437-1500	1-1/2										
-0437-1750	1-3/4										
-0437-2000	2						.459	.437	.0470	17/32	
-0437-2250	2-1/4										
-0437-2500	2-1/2										
-0437-2750	2-3/4										
-0437-3000	3										
-0437-3250	3-1/4										
-0437-3500	3-1/2	.456	+ .006/- .000								
-0500-1000	1										
-0500-1250	1-1/4										
-0500-1500	1-1/2										
-0500-1750	1-3/4										
-0500-2000	2						.525	.500	.0520	5/8	
-0500-2250	2-1/4										
-0500-2500	2-1/2										
-0500-2750	2-3/4										
-0500-3000	3										
-0500-3250	3-1/4										
-0500-3500	3-1/2						.523				
-0500-1000	1										
-0500-1250	1-1/4										
-0500-1500	1-1/2										
-0500-1750	1-3/4										
-0500-2000	2										
-0500-2250	2-1/4	.524									
-0500-2500	2-1/2										
-0500-2750	2-3/4										
-0500-3000	3										
-0500-3250	3-1/4										
-0500-3500	3-1/2										

GP-A

Three full-length tapered grooves. Ideal for applications requiring superior locking effect and ease of assembly. Use in place of taper pins, set screws, nuts, and lugs.

TYPE A



COMMON

1. Verify three full-length tapered grooves.
2. Measure diameter (D).
3. Measure length (L).
4. Find the part in the chart above.

TYPICAL PART NUMBER SEQUENCE:
GPS-0500-1250-A
is a 1/2" x 1-1/4", type A, stainless steel pin.

APPLICATION

Easy to install.

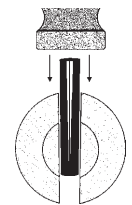

PERFORMANCE RESULTS VARY. YOUR PIN SELECTION SHOULD BE MADE BASED ON INDIVIDUAL APPLICATION.



ADDITIONAL
TECHNICAL DATA
ON PAGE 128.

DIN 1471



METRIC
Page 232

MOST SIZES AVAILABLE IMMEDIATELY • \$2 LINE REQUESTED • CALL FOR QUANTITY DISCOUNTS