

THREE QUARTER-LENGTH GROOVES

BOX 232 • MINNEAPOLIS, KS • 67467

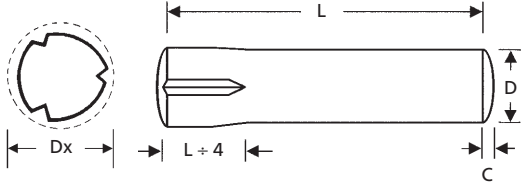

TYPE C			
MANUFACTURER CROSS-REFERENCE			
Driv-Lok	C	Groov-Pin	24

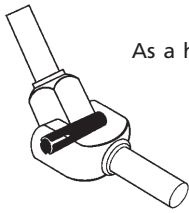

GP-C	Nominal (D)		Length (L)	Expanded Diameter (Dx)	Hole Size	Crown Height (C)	Crown Radius	WEIGHT	MATERIAL																	
	DIAMETER		LENGTH						Lbs. per 100 Pieces	Zinc Clear "GP-"	Alloy HIT "GPA-"	Stainless "GPS-"														
-0062-0250	1/16	+ .000/- .001	1/4	.068	.062	+ .002/- .000	.0065	5/64	0.02																	
-0062-0375			3/8										0.03													
-0062-0500			1/2											0.04												
-0062-0625			5/8												0.05											
-0062-0750			3/4													0.07										
-0062-0875			7/8														0.08									
-0062-1000	1	0.09																								
-0093-0250	1/4		.101	.093	.0091	1/8	0.06																			
-0093-0375	3/8							0.08																		
-0093-0500	1/2								0.10																	
-0093-0625	5/8									0.12																
-0093-0750	3/4										0.15															
-0093-0875	7/8	0.17																								
-0093-1000	1		0.20																							
-0093-1250	1-1/4			.100	.125	.0130	5/32	0.25																		
-0125-0250	1/4								.134			.125	.0130	5/32	0.09											
-0125-0375	3/8									0.13																
-0125-0500	1/2										0.17															
-0125-0625	5/8	0.22																								
-0125-0750	3/4		0.26																							
-0125-0875	7/8			0.30																						
-0125-1000	1				0.35																					
-0125-1250	1-1/4					.133	.156	.0170	3/16	0.48																
-0125-1500	1-1/2										.132	.156	.0170	3/16	0.44											
-0156-0375	3/8	.166														.156	.0170	3/16	0.68							
-0156-0500	1/2		0.27																							
-0156-0625	5/8			0.34																						
-0156-0750	3/4				0.41																					
-0156-0875	7/8					0.48																				
-0156-1000	1						0.54																			
-0156-1250	1-1/4	.164						.187	.0180	1/4	1.09															
-0156-1500	1-1/2		.163									.187	.0180	1/4	0.29											
-0156-1750	1-3/4			.198												.187	.0180	1/4	0.39							
-0156-2000	2				.198															.187	.0180	1/4	0.49			
-0187-0375	3/8					.198																		.187	.0180	1/4
-0187-0500	1/2						.198																			
-0187-0625	5/8	.198						.187	.0180	1/4	0.69															
-0187-0750	3/4		.198									.187	.0180	1/4	0.69											
-0187-0875	7/8			.198												.187	.0180	1/4	0.69							

GP-C	DESCRIPTION	GENERAL USE	HOW TO IDENTIFY	APPLICATION
TYPE C	Three quarter-length parallel grooves leave a long three-quarter lead for easy insertion. Smooth portion of pin is ideal as a hinge or pivot.	 UNCOMMON	<ol style="list-style-type: none"> 1. Verify three quarter-length parallel grooves. 2. Measure diameter (D). 3. Measure length (L). 4. Find the part in the chart above. <p>TYPICAL PART NUMBER SEQUENCE: GP-0062-0250-C is a 1/16" x 1/4", type C, steel zinc grooved pin.</p>	 As a hinge pin.

PERFORMANCE RESULTS VARY. YOUR PIN SELECTION SHOULD BE MADE BASED ON INDIVIDUAL APPLICATION.



MOST SIZES AVAILABLE IMMEDIATELY • \$2 LINE REQUESTED • CALL FOR QUANTITY DISCOUNTS

All manufacturer names and numbers are for identification purposes only. In no way are we implying that our parts were made by the manufacturers listed above. Prices, materials, tolerances, and grades subject to change without notice.

GROOVED PINS

785-392-3017 FAX 785.392.2845

REVISED 06-04
www.huyett.com

THREE QUARTER-LENGTH GROOVES

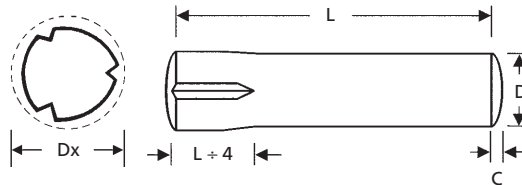

TYPE C

MANUFACTURER CROSS-REFERENCE

Driv-Lok	C	Groov-Pin	24
----------	---	-----------	----

GP-C	Nominal (D)	Length (L)	Expanded Diameter (Dx)		Hole Size	Crown Height (C)	Crown Radius	WEIGHT	MATERIAL					
	DIAMETER	LENGTH						Lbs. per 100 Pieces	Zinc Clear "GP-"	Alloy HIT "GPA-"	Stainless "GPS-"			
-0187-1000	3/16	1	.198		.187	.0180	1/4	0.78						
-0187-1250		1-1/4						0.98						
-0187-1500		1-1/2						1.17						
-0187-1750		1-3/4						1.37						
-0187-2000	2	.196		.230	.0220	9/32	1.57							
-0218-0500	1/2						0.53							
-0218-0625	5/8						0.67							
-0218-0750	3/4						0.80							
-0218-0875	7/8			0.93										
-0218-1000	7/32	1						.218				.0220	9/32	1.07
-0218-1250		1-1/4												1.33
-0218-1500		1-1/2												1.60
-0218-1750		1-3/4							1.87					
-0218-2000	2	.229		.250				.0260	5/16	2.13				
-0218-2250	2-1/4									2.40				
-0250-0500	1/2									0.70				
-0250-0625	5/8									0.87				
-0250-0750	3/4			1.04										
-0250-0875	7/8			1.22										
-0250-1000	1/4	1									.250	.0260	5/16	1.39
-0250-1250		1-1/4			1.74									
-0250-1500		1-1/2			2.09									
-0250-1750		1-3/4			2.44									
-0250-2000	2	.262		.261	.0340	3/8	2.78							
-0250-2250	2-1/4						3.13							
-0250-2500	2-1/2						3.48							
-0250-2750	2-3/4						3.83							
-0312-0625	5/16	5/8			.312	.0340	3/8				1.36			
-0312-0750		3/4									1.63			
-0312-0875		7/8						1.90						
-0312-1000		1	.329					.005/- .000	.0340	3/8	2.17			
-0312-1250	1-1/4			2.72										
-0312-1500	1-1/2			3.26										
-0312-1750	1-3/4			3.81										
-0312-2000	2	.328		.327			4.35							
-0312-2250	2-1/4						4.89							
-0312-2500	2-1/2						5.44							
-0312-2750	2-3/4						5.98							

DESCRIPTION	GENERAL USE	HOW TO IDENTIFY	APPLICATION
<p>GP-C</p> <p>Three quarter-length parallel grooves leave a long three-quarter lead for easy insertion. Smooth portion of pin is ideal as a hinge or pivot.</p> <p>TYPE C</p>	<p>UNCOMMON</p>	<ol style="list-style-type: none"> Verify three quarter-length parallel grooves. Measure diameter (D). Measure length (L). Find the part in the chart above. <p>TYPICAL PART NUMBER SEQUENCE: GPA-0218-0625-C is a 7/32" x 5/8", type C, alloy grooved pin.</p>	<p>Pivot hinge for a door.</p>

PERFORMANCE RESULTS VARY. YOUR PIN SELECTION SHOULD BE MADE BASED ON INDIVIDUAL APPLICATION.

ADDITIONAL TECHNICAL DATA ON PAGE 128.

DIN 1472 **METRIC** Page 237

MOST SIZES AVAILABLE IMMEDIATELY • \$2 LINE REQUESTED • CALL FOR QUANTITY DISCOUNTS

THREE QUARTER-LENGTH GROOVES

BOX 232 • MINNEAPOLIS, KS • 67467

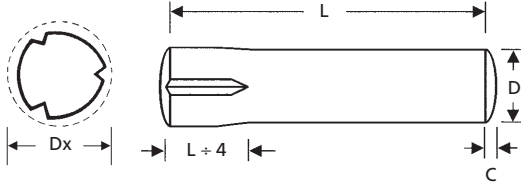

TYPE C			
MANUFACTURER CROSS-REFERENCE			
Driv-Lok	C	Groov-Pin	24

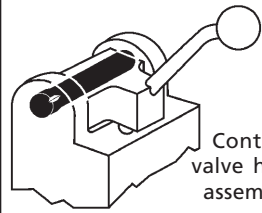

GP-C	Nominal (D)		Length (L)	Expanded Diameter (Dx)	Hole Size	Crown Height (C)	Crown Radius	WEIGHT Lbs. per 100 Pieces	MATERIAL		
	DIAMETER	LENGTH							Zinc Clear "GP-"	Alloy H/T "GPA-"	Stainless "GPS-"
-0375-0750	3/8	+ .000/- .002	3/4	.394	.375	+ .005/- .000	15/32	2.35			
-0375-0875			7/8					2.74			
-0375-1000			1					3.13			
-0375-1250			1-1/4					3.91			
-0375-1500			1-1/2					4.70			
-0375-1750			1-3/4					5.48			
-0375-2000			2					6.26			
-0375-2250			2-1/4					7.05			
-0375-2500			2-1/2					7.83			
-0375-2750			2-3/4					8.61			
-0375-3000	3	9.39	+/- .010	+/- .002	.437	.0470	17/32				
-0375-3250	3-1/4	10.18									
-0375-3500	3-1/2	10.96									
-0437-0875	7/8	3.73									
-0437-1000	1	4.26									
-0437-1250	1-1/4	5.33									
-0437-1500	1-1/2	6.39									
-0437-1750	1-3/4	7.46									
-0437-2000	2	8.52									
-0437-2250	2-1/4	9.59									
-0437-2500	2-1/2	10.66									
-0437-2750	2-3/4	11.72									
-0437-3000	3	12.79									
-0437-3250	3-1/4	13.85									
-0437-3500	3-1/2	14.92									
-0500-1000	1/2	+ .000/- .002	1	.525	.500	+ .006/- .000	5/8	5.57			
-0500-1250			1-1/4					6.96			
-0500-1500			1-1/2					8.35			
-0500-1750			1-3/4					9.74			
-0500-2000			2					11.30			
-0500-2250			2-1/4					12.53			
-0500-2500			2-1/2					13.92			
-0500-2750			2-3/4					15.31			
-0500-3000			3					16.70			
-0500-3250			3-1/4					18.09			
-0500-3500	3-1/2	19.48									

GP-C	DESCRIPTION	GENERAL USE	HOW TO IDENTIFY	APPLICATION
TYPE C	Three quarter-length parallel grooves leave a long three-quarter lead for easy insertion. Smooth portion of pin is ideal as a hinge or pivot.	 UNCOMMON	<ol style="list-style-type: none"> 1. Verify three quarter-length parallel grooves. 2. Measure diameter (D). 3. Measure length (L). 4. Find the part in the chart above. <p style="background-color: #ffcc99; padding: 2px;">TYPICAL PART NUMBER SEQUENCE: GPS-0375-3250-C is a 3/8" x 3-1/4", type C, stainless steel pin.</p>	 Control valve hinge assembly.

PERFORMANCE RESULTS VARY. YOUR PIN SELECTION SHOULD BE MADE BASED ON INDIVIDUAL APPLICATION.



MOST SIZES AVAILABLE IMMEDIATELY • \$2 LINE REQUESTED • CALL FOR QUANTITY DISCOUNTS

All manufacturer names and numbers are for identification purposes only. In no way are we implying that our parts were made by the manufacturers listed above. Prices, materials, tolerances, and grades subject to change without notice.