

# CLEVIS ASSEMBLY W/STRAIGHT ROD

PART# \_\_\_\_\_

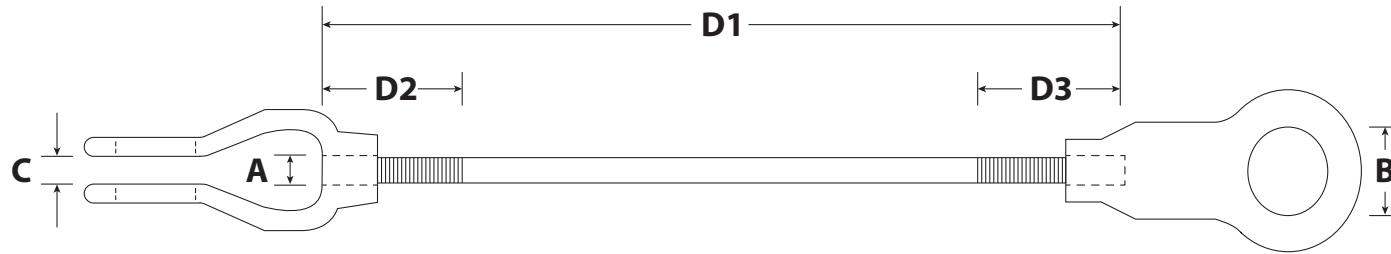

Unless otherwise noted, finished assembly includes 2 Clevis Pins with Cotter Pins.

Dimension	Description	Value	Tolerance
A	Thread Size		Typical – Select: RH / LH
B	Hole Size		+0.015 / -0
C	Grip		+/- .060
D1	Rod Length		+/- .125
D2	Rod Thread Length		Minimum – Select: RH / LH
D3	Rod Thread Length		Minimum – Select: RH / LH

Clevis Size: 2 2-1/2 3  
 Tap Size/Pitch: \_\_\_\_\_  
 Material: \_\_\_\_\_ 1045 Carbon Steel  
 Finish: \_\_\_\_\_  
 Other Requirements: \_\_\_\_\_

For safety information, rated capacities, weight, and safe lifting practices, visit [www.huyett.com/LiftingHardware](http://www.huyett.com/LiftingHardware).

## DESIGN APPROVAL

1. All prints must be signed and approved **before** production begins.
2. Specials cannot be returned. See terms and conditions at [www.huyett.com/terms](http://www.huyett.com/terms).
3. Send completed prints to [quotes@huyett.com](mailto:quotes@huyett.com).

NAME: \_\_\_\_\_

TITLE: \_\_\_\_\_

DATE: \_\_\_\_\_

SIGNATURE: \_\_\_\_\_



1215 E. 8th St.  
 Minneapolis, KS 67467  
 PH: 785.392.3017 Fax: 785.382.2845  
[www.huyett.com](http://www.huyett.com)

Rev.	Date	Comment	Drawn By:

**Note:** When Hot Dipped Galvanized (HDG) is specified, Internal Threads will be oversized and External Threads will be undersized. Unless otherwise requested, the Internal Threads on Hot Dipped Galvanized (HDG) parts may be plain or coated at the manufacturer's option.